

# sx-H-02 Installation Instruction

## 1. Hardware and parts list:

NO.	Item	Photo	QTY	NO.	Item	Photo	QTY
1	Base Plate		1pc	2	Support Leg		1pc
3	Middle rail		1pc	4	Upper rail		1pc
5	Plastic connector		2pcs	6	Mounting screws		4pcs
7	Screws		6pcs	8	Acorn nuts		4pcs

## 2. Installation Steps:

STEP1, Attach base plate to support leg with 4 mounting screws and nuts.

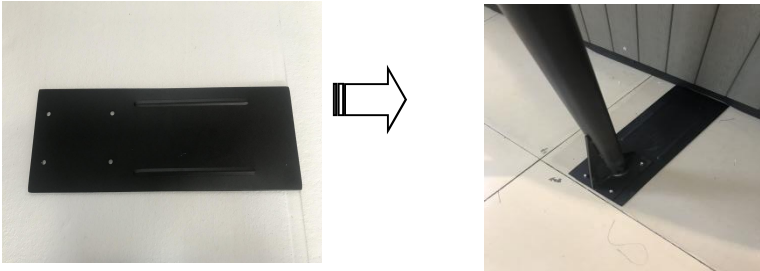

STEP2, Use 1pc plastic connector to connect the middle rail and support leg. Then tighten 4pcs screws on the pilot holes.

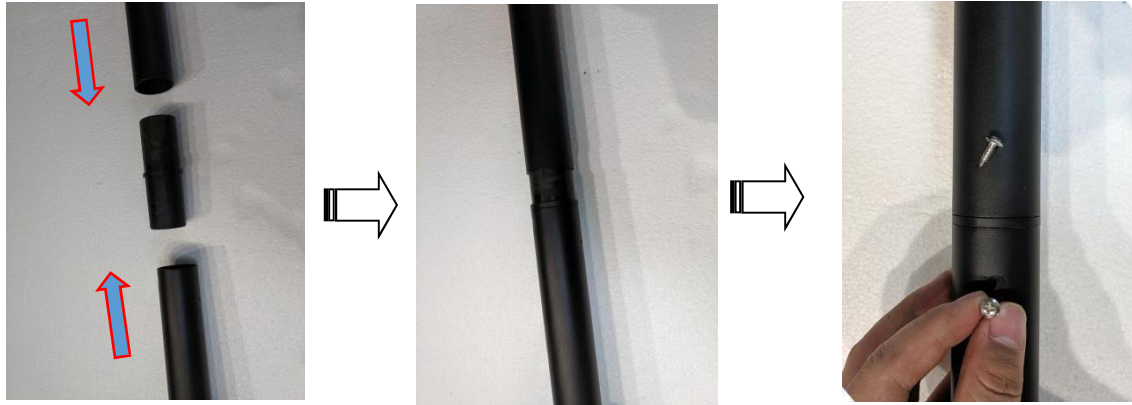

STEP3, Same as STEP2, Use another 1pc plastic connector(with an adjustable button) to connect the upper rail and middle rail. Then tighten 2pcs screws on the pilot holes.

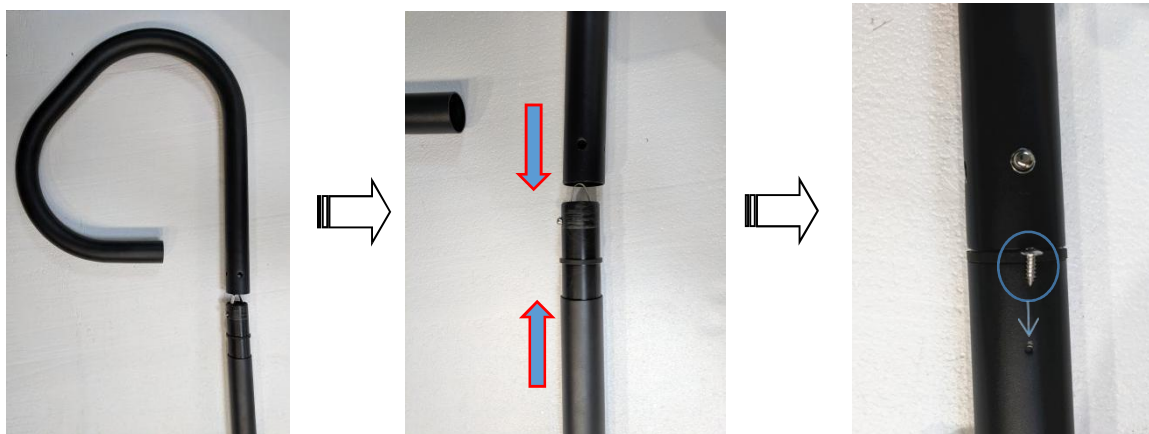

STEP4, Slide the base plate under the spa in your desired position, and then you can adjust the upper rail with adjustable button when you use it.



Note - if installed with the undermount bracket or direct to a conductive surface (including undermount bracket sitting on concrete under the spa), this cover lifter must be earth bonded by your electrician.